

THIS DRAWING IS UNPUBLISHED. RELEASED FOR PUBLICATION
 (C) COPYRIGHT 19 BY AMP INCORPORATED. ALL RIGHTS RESERVED.

LOC	DIST	REVISIONS			
P	LTR	DESCRIPTION	DATE	DWN	APVD
		REV PER 0G3C-0298-01	29JUL02	RB	DS

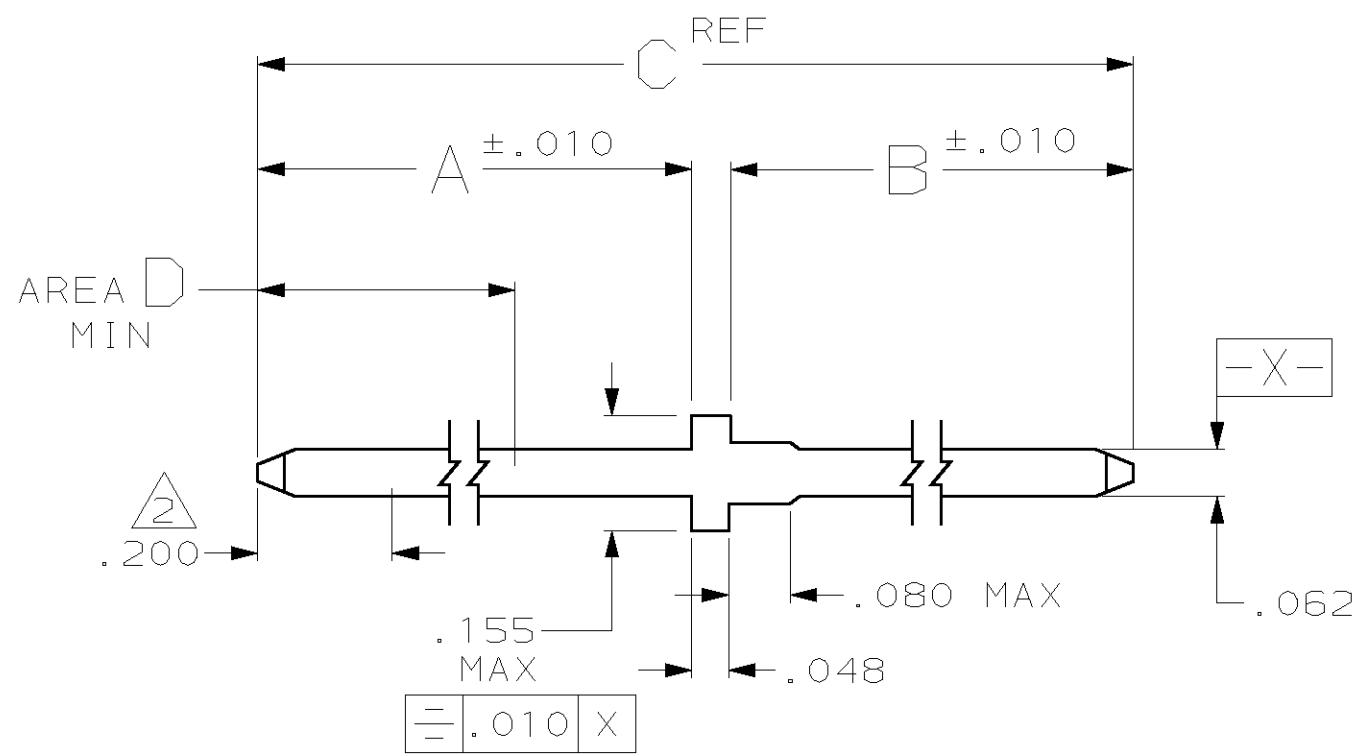

- 1 THIS POST IS NOT COMPATIBLE WITH TERMI-POINT APPLICATIONS.
- 2 POINT OF MEASUREMENT FOR PLATING THICKNESS.
- 3 .000015 MIN OVER .000050 MIN NICKEL.
- 4 .000030 MIN GOLD OVER .000050 MIN NICKEL.
- 5 .000100-.000200 BRIGHT TIN OVER .000030 NICKEL.
- 6 .000030 GOLD IN AREA D, .000100-.000200 BRIGHT TIN-LEAD ON TERMINATION AREA, ALL OVER .000050 NICKEL ENTIRE POST.
- 7 .000015 GOLD IN AREA D, .000100-.000200 BRIGHT TIN-LEAD ON TERMINATION AREA, ALL OVER .000050 NICKEL ENTIRE POST.
- 8 OBSOLETE PART NUMBER.
- 9 BRASS #4 HARD.

D	C	B	A	FINISH	PART NUMBER
.690	.998	.150	.800	7	5-86182-1
.640	1.175	.375	.750	8	5-86182-0
.625	.875	.092	.735	8	4-86182-9
.560	.843	.125	.670	8	4-86182-8
.455	.800	.187	.565	8	4-86182-7
.250	.595	.187	.360	8	4-86182-6
.240	.798	.400	.350	7	4-86182-5
.890	1.198	.150	1.000	6	4-86182-4
.690	.998	.150	.800	8	4-86182-3
.560	.843	.125	.670	8	4-86182-2
.490	1.273	.625	.600	8	4-86182-1
.460	.748	.130	.570	8	4-86182-0
.455	1.143	.530	.565	8	3-86182-9
.455	.800	.187	.565	8	3-86182-8
.370	.715	.187	.480	8	3-86182-7
.290	.573	.125	.400	8	3-86182-6
.270	.748	.320	.380	8	3-86182-5
.250	.595	.187	.360	8	3-86182-4
.240	.798	.400	.350	6	3-86182-3
	.828	.530	.250	5	3-86182-2
	.798	.400	.350	3	3-86182-1
	.595	.187	.360	3	3-86182-0
	.573	.125	.400	4	2-86182-9
	.875	.092	.735	3	2-86182-8
	1.198	.150	1.000	5	2-86182-7
	.748	.130	.570	5	2-86182-6
	.573	.125	.400	5	2-86182-5
	.798	.400	.350	4	2-86182-4
	.843	.125	.670	5	2-86182-3
	.715	.187	.480	5	2-86182-2
	1.175	.375	.750	3	2-86182-1
	.748	.130	.570	4	2-86182-0
	.798	.400	.350	5	1-86182-9
	.715	.187	.480	4	1-86182-8
	.843	.125	.670	3	1-86182-7
	1.198	.150	1.000	4	1-86182-6
	.748	.320	.380	4	1-86182-5
	.800	.187	.565	3	1-86182-4
	.998	.150	.800	3	1-86182-3
	.998	.150	.800	4	1-86182-2
	.843	.125	.670	4	1-86182-1
	.998	.150	.800	5	1-86182-0
	.748	.320	.380	5	86182-9
	.800	.187	.565	4	86182-8
	.595	.187	.360	4	86182-7
	1.143	.530	.565	4	86182-6
	1.273	.625	.600	4	86182-5
	1.273	.625	.600	5	86182-4
	1.143	.530	.565	5	86182-3
	.595	.187	.360	5	86182-2
	.800	.187	.565	5	86182-1

THIS DRAWING IS A CONTROLLED DOCUMENT.		DWN B. HAYMAKER	AMP Incorporated Harrisburg, PA 17105-3608	
DIMENSIONS: MM(INCH)		CHK M. ZITTO	NAME CONTACT, MALE, MOD I LOOSE PIECE .031X.062	
TOLERANCES UNLESS OTHERWISE SPECIFIED:		APVD M. ZITTO	SIZE A2 00779	
0 PLC ± 1 PLC ± 2 PLC ± 3 PLC ±0.13(.005) 4 PLC ± ANGLES ±		PRODUCT SPEC -	DRAWING NO C- 86182	
MATERIAL -		APPLICATION SPEC -	RESTRICTED TO -	
FINISH -		WEIGHT -	SCALE 4:1	
CUSTOMER DRAWING		SHEET 1 OF 1		REV L